

应用场所 Application

- ◆ 适用于直升机平台状态指示;
- ◆ 适用于爆炸性环境1区, 2区, 21区, 22区等场所;
- ◆ 适用于环境温度: $-40^{\circ}\text{C}\sim+50^{\circ}\text{C}$ 。
- ◆ Used as status light on helideck;
- ◆ Explosive hazardous atmosphere zone 1, zone2, zone 21, zone22;
- ◆ Suitable for temperature of $-40^{\circ}\text{C}\sim+50^{\circ}\text{C}$.

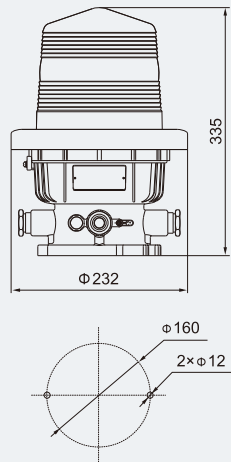

外形尺寸 Outline dimension



产品特性 Features

- ◆ 壳体采用海工专用铝合金压铸成型, 经特殊防腐处理后表面喷塑;
- ◆ 采用国际品牌LED光源, 内装集成芯片, 具有多种保护电路, 性能可靠;
- ◆ 硅橡胶密封圈, 防护等级高;
- ◆ 采用聚碳酸酯透明罩, 在暴晒、雨露、冰雹等系列恶劣环境中均能正常工作;
- ◆ 红色闪烁发光, 闪烁频率显示危险状态指示, 符合CAP437标准要求;
- ◆ 内置接线端子, 适用于导线: $\leq 3 \times 2.5\text{mm}^2$ 。
- ◆ Enclosure is made of maritime special aluminium alloy, powder coated surface after special corrosion-proof treatment;
- ◆ International brand of LED light source, built-in integrated chip, various protection circuit, stable performance;
- ◆ Silicon rubber sealing ring, of high protection degree;
- ◆ PC transparent cover, can be worked normally in the severe environment, such as sun, rain and hail etc.;
- ◆ Red flashing light, flash frequency can show the hazardous situation, conforms to the requirements of CAP437;
- ◆ Built-in terminal, suitable for conductor: $\leq 3 \times 2.5\text{mm}$.

2

选配表 Selection table

型号 Model	额定电压(V) Rated voltage	额定功率(W) Rated power	防爆标志 Ex-Mark	光源类型 Lamp	防护等级 Degree of protection	进线规格 Cable entry	重量(kg) Weight
HDL-S	220/230V AC 50/60Hz 24V DC	60	Ex d e IIC T6 Gb Ex tD A21 IP66 T80°C	LED	IP66	4×M25×1.5	4.0

- ◆ 产品出厂时不配防爆格兰, 如有需求, 订货时请注明;
- ◆ 如需其他特殊要求, 订货时请注明。

- ◆ The product is supplied without explosion-proof cable gland. If needed, please specify when ordering;
- ◆ If other special requirements needed, please specify when ordering.

Zones 1&2; 21&22